



# Drying and Warming Cabinets

For Hospitals and Medical Centers



Drying Cabinet Line

# Drying and Warming Cabinets

Energy efficient cabinets for drying and warming applications in hospitals, medical centers, and nursing homes.

## Anesthesia Circuits

### Dry-Ans

Drying a combination of surgical instruments and anesthesia circuits



## Surgical Instruments

### Dry-10D

Drying surgical instruments alone



## Blankets

### Dry-10B

Warming Cabinet version for blankets



## Features

- Anti-corrosive stainless steel AISI 304
- USB connection for digital records
- Automatic alarm when filter change is required
- Two PT 1000 interior probes for precise temperature control
- Easy to use glass touch control panel and color LCD screen
- Acoustic-thermal insulation -the temperature of glass door does not exceed 32°C
- Ethernet port for traceability system

## Designed for Energy Efficiency

A built-in quiet forced air system for efficient moisture removal and fast drying time. 50% of the air is recycled reducing energy consumption. A HEPA 14 filter for particles over 0.3 micron in size ensures safe clean air intake.



## Drying and Warming Cabinets For Hospitals and Medical Centers

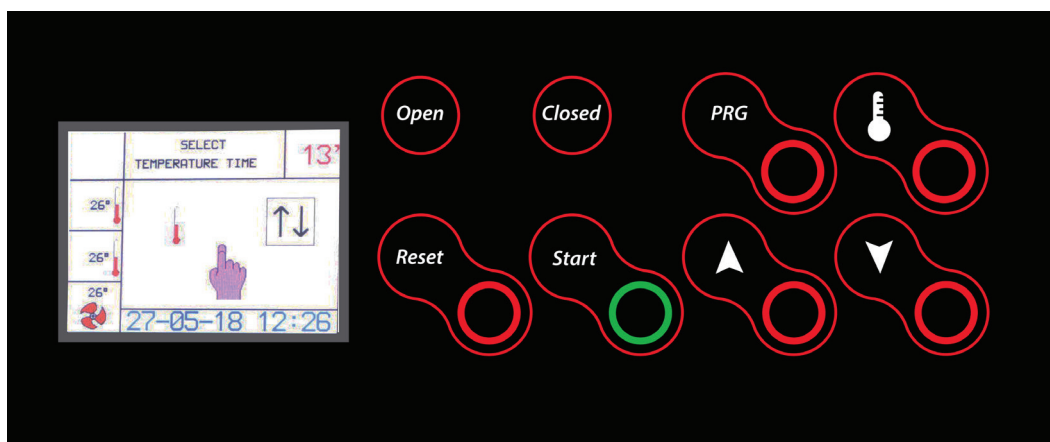

### Anesthesia Circuits | Dry-Ans

For drying anesthesia bags and hoses, and surgical instruments  
Effective drying due to deep penetration of heated air into bags, hoses and instruments. Air supplied from the top of the cabinet.

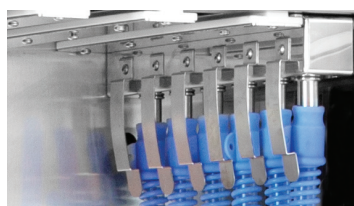

Anesthesia Hose Drawer



Surgical Instruments Shelf



Anesthesia Bags Drawer

#### Shelves and Drawers Included

- 3 drawers for 6 anesthesia bags, for total 18 bags
- 3 drawers for 6 anesthesia tubes, for total 18 tubes
- 5 shelves to hold instruments DIN baskets (DIN baskets not included)

### Surgical Instruments | Dry-10D

#### For Drying Surgical Instruments

Effective drying due to circulation of heated air around surgical instruments. Shelves can be removed to make room for taller loads.

#### Shelves Included

10 shelves for DIN baskets (DIN baskets not included)



### Blankets | Dry-10B

#### For Warming Blankets

Air supplied from the side of the cabinet. Shelves can be removed to make room for taller loads.

#### Shelves Included

10 shelves to hold warming blankets.



## Technical Specifications

Weight	180 kg
Width x Depth x Height	700 x 450 x 1900 mm
Air Flow Rate	100 m <sup>3</sup> /h
Noise Level	60 dBa
Chamber Volume	365 Liters

Voltage	Frequency	Power (Max)	Current
230 V 1-Ph	50-60 Hz	3100 W	13 A
230 V 3-Ph			
400 V 3-Ph N			

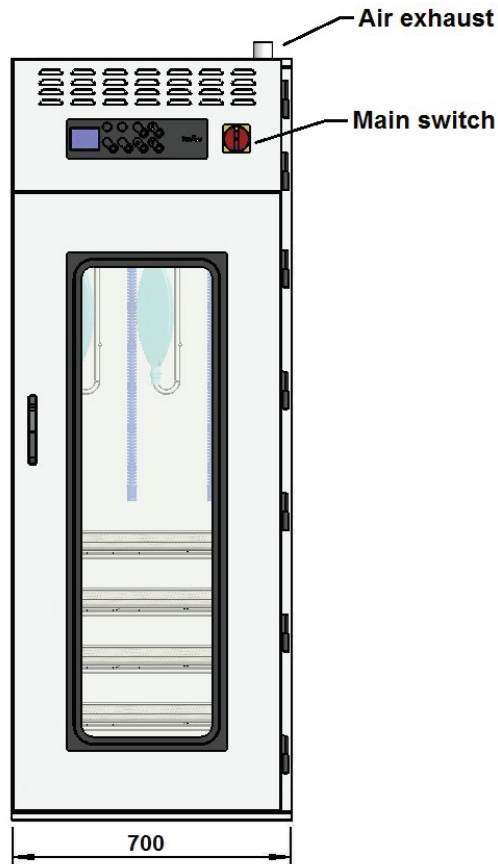

Front View

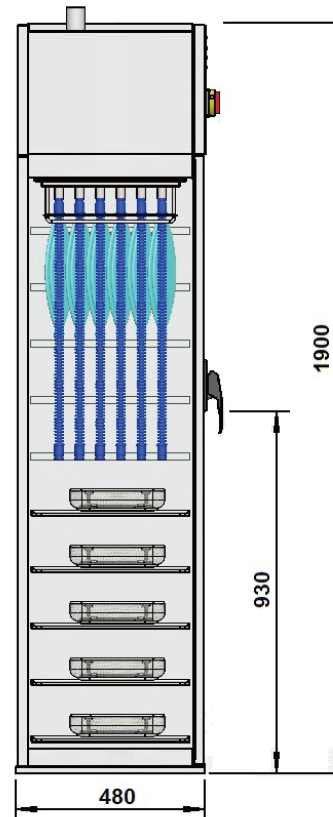

Side View

 Learn from our Experts  
Join our blog [tuttnauer.com/blog](http://tuttnauer.com/blog)



## Drying Cabinet Line

International Sales and Marketing  
E-mail: [info@tuttnauer.com](mailto:info@tuttnauer.com), [tuttnauer.com](http://tuttnauer.com)

Tuttnauer Europe b.v.  
Hoeksteen 11, 4815 PR  
P.O.B. 7191, 4800 GD Breda  
The Netherlands  
Tel: +31 (0) 765 423 510  
Fax: +31 (0) 765 423 540  
E-mail: [info@tuttnauer.nl](mailto:info@tuttnauer.nl)

Tuttnauer USA Co.  
25 Power Drive,  
Hauppauge, NY 11788  
Tel: +800 624 5836,  
+631 737 4850  
Fax: +631 737 0720  
E-mail: [info@tuttnauerUSA.com](mailto:info@tuttnauerUSA.com)

  
Your Sterilization & Infection Control Partners

Distributed by:

LTR330-0094/WAS/REVO/03.18